



# Smart Phone Remote Speaker Microphone

## RT-SHM1

# User's Guide

### Important Notice

#### Thank You Notice

Thank you for purchasing RT-SHM1 Smart Phone Remote Speaker Microphone. Please read this User's Guide carefully before putting RT-SHM1 into operation. Support for the RT-SHM1 is available by email. Please direct all questions via email to ***support@radio-tone.com***. Your question(s) will be answered promptly.

#### Electrical shock hazard

- Never attempt to connect the unit to any power network other than one for which it was intended.
- Do not open the housing of the units.
- Disconnect the unit from any power supply and from all other devices if a fault occurs.
- Install the unit only in a dry place protected against the elements.
- If you are uncertain about the safe operation of the unit, shut it down immediately and secure it to prevent any unauthorized start-up. Safe operation is no longer possible, for example,
  - if damage is visible to the unit or the cables,
  - if the unit no longer operates correctly,
  - if objects have penetrated inside the unit,
  - after long storage under improper conditions

Have the system checked by qualified, specialist personnel in such cases.

#### Installation and operation

- Before installing or operating the system, ensure that you have read and understood the documentation for other equipment connected to the unit. These contain important safety notices and information concerning permissible applications.
- Perform only the installation and operating work described in this guide. All other work beyond this may lead to injuries to persons and damage to the system or other equipment.

## Repairs and maintenance

Never open the housing of the RT-SHM1. The unit contains no parts which you can repair or replace. Ensure that only qualified, specialist personnel (electrical technicians) are permitted to carry out maintenance or repair work.

## Disclaimer

Customers and/or users are taking full responsibilities and all risks in using this product. We are not responsible for any direct or indirect losses caused by, but not limited to, communication failures as a result of product failure or network problems.

## Preface

The RT-SHM1 Smart Phone Remote Speaker Microphone is the perfect accessory for turning your smart phone into a traditional 2-way radio radio-style PTT device, brings you the fast and stable push-to-talk communication anytime and anywhere over the world!

## Key Features

The key features of RT-SHM1 are:

- **Support Push-to-Talk Mode and Toggle Mode**
- **Remote Mobile Phone Volume Control (Support most Android phones)**
- **High Quality and High Power Audio Output**
- **High Sensitivity Microphone**
- **Built-in Rechargeable Battery**
- **Support Different OS Smart Phones**

## Product Descriptions

### Packing List

- RT-SHM1 Smart Phone Remote Speaker Microphone x 1
- USB Charging Cable x 1
- This User's Guide x 1

# Major Operating Controls, Terminals and Their Functions

## 1. Power ON/OFF Switch

This is the power on/off switch. Push and hold this switch until the status indicator light up to power on.

## 2. PTT Button

This is PTT button. Voice message will be transmitted when push-and-hold this button.

## 3. Volume Control Buttons

These switches are used to control the volume of connected mobile phone (work for most Android phones. Maybe no effect for some old phones.).

## 4. Microphone

This is a audio input microphone.

## 5. Speaker

This is audio output speaker.

## 6. External Earpiece & Battery Charge Power Source Terminal

This terminal is used to connect to an earpiece, or external DC5V power source for battery charging.

## 7. Audio Input and Output plug

This 4-pin 3.5mm plug is used to plug into the earphone terminal of smart phone.

## 8. Status Indicator

This is the microphone status indicator.



Operation	Status Indicator
Battery Changing	Light Up with RED color
Turn On Power(push and hold the power button)	Light up with GREEN color
Push the PTT Button to Talk (when power is on)	Light up with GREEN color
Turn Off Power(push and hold the power button)	Off
Standby & Receiving Call	GREEN color 1 short blinking
Low Battery Power	GREEN color 4 short blinking

# Installation

## Simple System Connection Diagrams



- Plug in the RT-SHM1 to a smart phone.
- Turn on the power of RT-SHM1, the status indicator will blink.
- Run the communication apps, such as Azetti PTT/PoC and Zello.

## Specifications

Power Supply	: Built-in 3.6V Rechargeable Battery
Power Consumption	: 25mA (Power ON Typical), 3uA (Power OFF Typical)
Charging Power Supply	: DC 5V 500mA (Maximum)
Control Buttons	: PTT, Vol Up and Vol Down
Smart Phone Connection	: 4-pin 3.5mm Phone Plug
Audio Output Power	: 1W (maximum)
Dimensions	: 155(W) x 155(D) x 55(H) mm (packing)
Weight	: 250 g (with packing)

- *Weight and dimensions indicated are approximate.*
- *Specifications are subject to change without notice.*

# Apps Setup

## Setup Azetti PTT/PoC App

- Run the Azetti **PTT** app.
- Enter *Provider Code*, *Username* and *Password* when you 1<sup>st</sup> time setup.
- Press the [**MENU**] button to pop-up the menu.
- Press the [**Settings**] item to open the setup menu.
- Press the [**Devices**] item to open the device setup menu.
- Confirm the setting of [**Handset**] is selected as “**Press and hold**”.
- Press the [**BACK**] button to exit setup.

## Setup Zello App

### Android Version

- Run the **Zello** app
- Add an account when you 1<sup>st</sup> time setup.
- Press the [**MENU**] button to pop-up the setup menu.
- Press the [**Options**] item to open the Options setup menu.
- Press the [**Under the hood**] item.  
Press the [**Map**] icon to map the PTT key.  
Press the PTT button of RT-SMK1 connected microphone, the PTT key of handset should be mapped.  
Select the [**Hard button action**] value as “**Hold to talk**”.
- Press the [**BACK**] button to exit.

### iOS Version

- Run the **Zello** app
- Add an account when you 1<sup>st</sup> time setup.
- Press the [**Options**] item to open the Options menu.
- Press the [**Settings**] item to open the settings menu.
- Press the [**PTT button**] item open the PTT button menu.  
Press the [**Action**] item to select the “**Press and hold**”.
- Turn on the [**Headset/remote control**] item.

# Operation

After the RT-SHM1 is installed and the app is setup correctly, the Smart Phone can be operated like a traditional 2-way radio. You are ready to start your PTT experience!

**Note: (1) The Zello Android works in true PTT mode, but the iOS version functions only in Toggle mode.**

**(2) If you use iOS Zello, you MUST plug in the RT-SMK1 into your smart phone before run the app, otherwise, the PTT button is disabled by the app.**

**(3) The volume buttons don't function on iOS and some Android smart phones.**

## Android Zello Setup

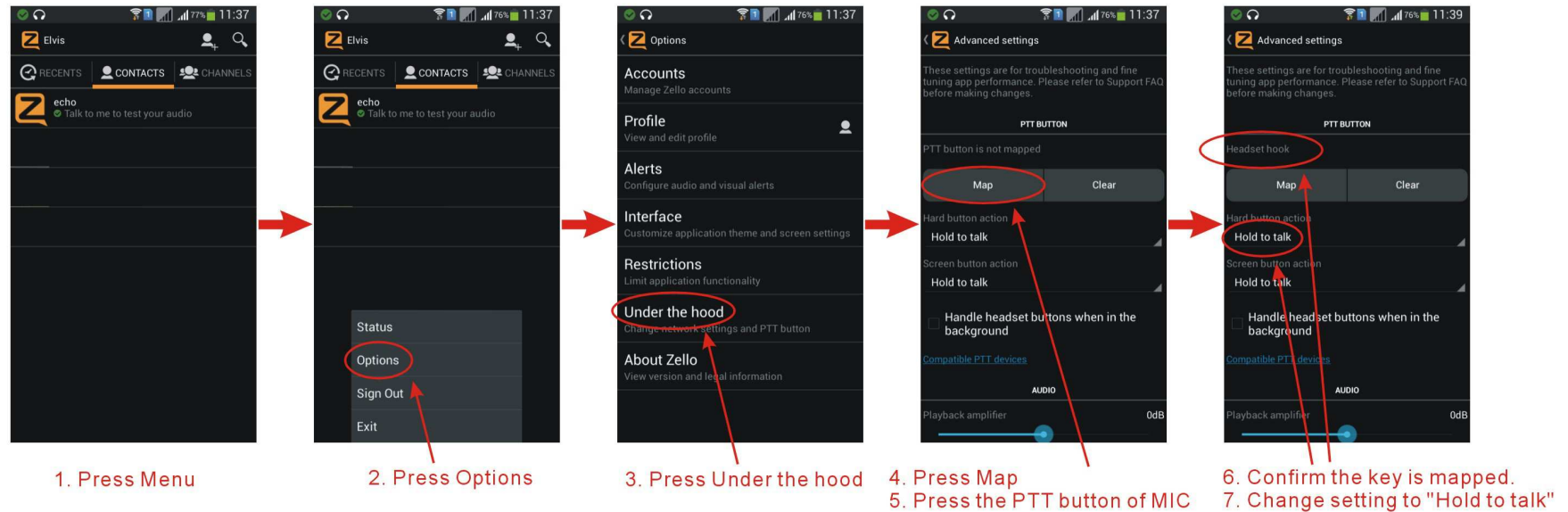

## iOS Zello Setup

